



ABOUT US

Bizproproperties Pvt Ltd - the company has rich experience in plotted development with amenities for more than a decade. We believe in appreciation of land as an asset class and help identifying right areas in the real estate landscape. Our philosophy is usage of any asset while it compounds & has successfully led us to see a great community built in our 40 acre adjoining property with residents enjoying a flourishing community with all resources.

A Plot of Prosperity! A Plot of Opportunity!

Developed by Bizpro Properties Pvt. Ltd., Golden Mile comprises 180 plots of opportunities, which you can never miss; perfectly spread over 40 acres of lush greenery. With excellent connectivity, modern amenities and a large clubhouse, Golden Mile is a golden opportunity for those who believe that nothing comes easy in life.

The residential layout is abundantly blessed with fruit bearing plants and trees, thereby offering you a privilege of indulgence till you decide to build your dream home. Golden Mile is an ideal development for investment wherein returns are sure to be enhanced manifold!



Mango



Lychee



Lemon



GOLDEN MILE
ANNEX

MASTER PLAN



A Plot of Recreation!

A Plot of Relaxation!

Golden mile believes in the all round well-being of each of its dwellers. It thus offers state-of-the-art clubhouse with a host of recreational facilities, designed exclusively for a sound body, mind and spirit!

CLUBHOUSE FEATURES:

- Multi equipped gymnasium for a complete fitness environment
- Badminton court
- Indoor games facility
- Lawn Tennis Court
- Billiards & Snooker Room
- Swimming pool with changing rooms
- Restaurants
- Cottages
- Multipurpose hall for all occasions
- Garden Restaurant

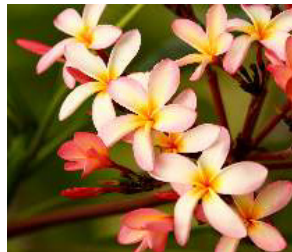
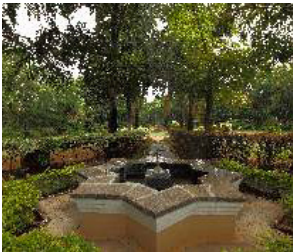

A Plot of Blissful Living!

A Plot of Luxury!

Having a plot in Golden mile, earns you a prerogative to own a host of amenities this splendid residential haven has to offer. There cannot be a better metaphor to exemplify or signify a truly blissful and luxurious life. Golden Mile is an investment of today in an asset, of tomorrow.

FEATURES:

- Approved by Directorate of Town and Country Planning, Chennai (DTCP) and Hosur New Town Development Authority (HNTDA)
- 24 x 7 Security, with compound wall all around
- Excellent connectivity from Silk Board, Sarjapur and Hosur
- Close to IT hubs such as Electronic City, Wipro, ITPL, Sarjapur and Marathahalli Ring Road
- The 40 feet main roads and 30 feet arterial roads are lined with Royal Palms, ornamental trees, Hedge plants and street lights
- 20 ornamental and fruit yielding trees in every plot e.g. Mango, Lychee, Orange, Fig etc.
- Fully equipped clubhouse with modern amenities
- Custom made villa options
- Storm water drainage, Water and Electricity connection
- 4 large parks
- Space reserved for school, medical facility and shops
- Bank Loans Available

Build your second home in 3 months

Community

- Build your getaway home just 40 min drive from the city
- Niche community of 20 like minded families
- Security guards with CCTV Nature conservatory environment
- Sustainable energy, rainwater harvesting & waste management
- Luxury Hospitality Experience
- Personal Lifestyle oriented design flexibility

USE YOUR ASSET WHILE
YOU SEE IT GROW



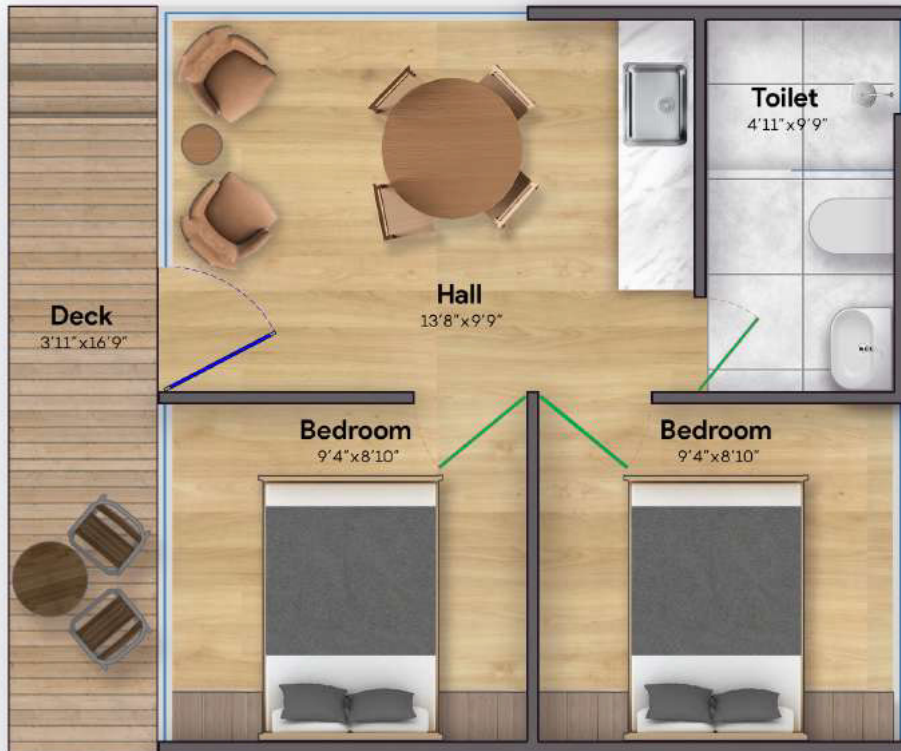

Sustainable Home Details

PROPERTY MANAGEMENT

RENTAL

- Housekeeping of property when no in use
- Supervision with CCTV
- Secondary rental management through hospitality listings to yield rental income

**OWN YOUR ASSET
WITH NO HASSLES**

A Plot of Convenience! A Plot of Excellent Connectivity!

Golden Mile is ideally located in between Bangalore City and Hosur. A couple of minutes drive from Electronic city and Whitefield, this gated residential development symbolizes a truly blessed living amidst its serene exteriors!

Location Map



LOCATION HIGHLIGHTS:

- Situated close to Hosur, which is soon to become a Satellite Township with a SEZ
- Located 22 kms from Electronic City and ITPL, ideal for software professionals
- Elevated highway on Hosur Road reduces travel time
- Good connectivity to the new Bangalore International Airport, Devanahalli
- 30 minutes drive from from Silk Board
- All the day to day life requirements can be met with ease
- Proximity to reputed educational institutions like Indus International School, Gear International School etc